



# Personal Safety Information Checklist

This document is mainly for the owner's reference.

Owner's name \_\_\_\_\_

## Emergency information

In the event of an **emergency**, you should know where the following **equipment and egress routes** are located: (i.e., include all of the areas that you work in). You can find this information in **Building Emergency Response Plan ([BERP ESB](#), [BERP EOSM](#), [EOSS](#))**, in the **Appendix 2: Emergency Response Key Plans**.

Work location (e.g., ESB room 2020)	Fire alarm	Fire extinguisher	Nearest emergency exit

Designated meeting area or muster station(s) for your work location(s) (Consult the end of this document to find the muster station of all buildings)



# Personal Safety Information Checklist

## Personal protective equipment

Your supervisor (or delegate) should provide appropriate orientation and training in the use and care of any PPE or clothing that is required to safely perform your work. Required PPE has to be provided.

Hazardous material and emergency response information (If you will not work in a laboratory tick this field and skip this section).

In case of spill or an event in which you come into contact with a **hazardous material**:

Item	Room number	Specific location in the room
<b>Eyewash and emergency shower</b>		
<b>Material Safety Data Sheets</b>		
<b>Chemical Spill Kit</b>		
<b>Biological Spill Kit</b>		

## Safety concerns and reporting hazards

If you have any concerns or hazards to report, contact any of the [Local Safety Team members](#).

## Additional resources

- [Review the Lab and Department Safety section in the EOAS website](#)
- Building emergency response plans:  
[ESB](#)  
[EOS-Main](#)  
[EOS-South](#)



# UBC Emergency Contacts

## Call 9-1-1

POLICE | FIRE | AMBULANCE | HAZARDOUS SPILL

RCMP Non-Emergency: 604-224-1322

Important: When calling 9-1-1, please provide the address of the building you are in or closest to.

For information during a campus emergency, visit [www.ubc.ca](http://www.ubc.ca)

BUILDING NAME: \_\_\_\_\_

BUILDING ADDRESS: \_\_\_\_\_

### CAMPUS SECURITY

UBC Campus Security.....604-822-2222  
AMS SafeWalk.....604-822-5355

### FIRST AID

Medical Emergencies..... 9-1-1, then call First Aid  
UBC Faculty, Staff, and Student-staff.....604-822-4444  
UBC Students and Visitors..... 604-822-2222  
Locate the closest defibrillator.....[srs.ubc.ca/defibrillators](http://srs.ubc.ca/defibrillators)

### SAFETY

Safety & Risk Services (SRS) ..... 604-822-2029  
Biological & Radiation Safety ..... 604-822-4353  
Chemical Safety ..... 604-827-3409  
Emergency Management..... 604-822-1237  
UBC Equity & Inclusion ..... 604-822-6353  
UBC Counselling Services ..... 604-822-3811  
UBC Student Health..... 604-822-7011  
AMS Sexual Assault Support Centre ..... 604-827-5180  
Sexual Violence Prevention & Response (SVPRO) ..... 604-822-1588  
Report an Accident or Incident.....[www.cairs.ubc.ca](http://www.cairs.ubc.ca)

#### FOR MORE INFORMATION

Safety & Risk Services  
[srs.ubc.ca](http://srs.ubc.ca)  
604-822-2029

Download the  
UBC Safe Vancouver App



[srs.ubc.ca/ubcsafe](http://srs.ubc.ca/ubcsafe)





Bio Sciences - West

Beaty Biodiversity

- LEGEND -

EXIT



Muster point



FIRE HYDRANT



MAIN MALL



FIRE ANNUNCIATOR PANEL

FIRE HYDRANT

Scarfe-Education Ofc

Muster point

Muster point

Earth Sciences Building

Scarfe-Lecture Block

Scarfe-Office

Scarfe - Library

EDUCATION ROAD

BASEMENT FLR.

EOS - Main

EOS - South

STORES ROAD

FIRE HYDRANT

FOR EMERGENCIES CALL 911

Earth Sciences Building  
2207 MAIN MALL, VANCOUVER, B.C.

SITE MAP - POINT GREY CAMPUS



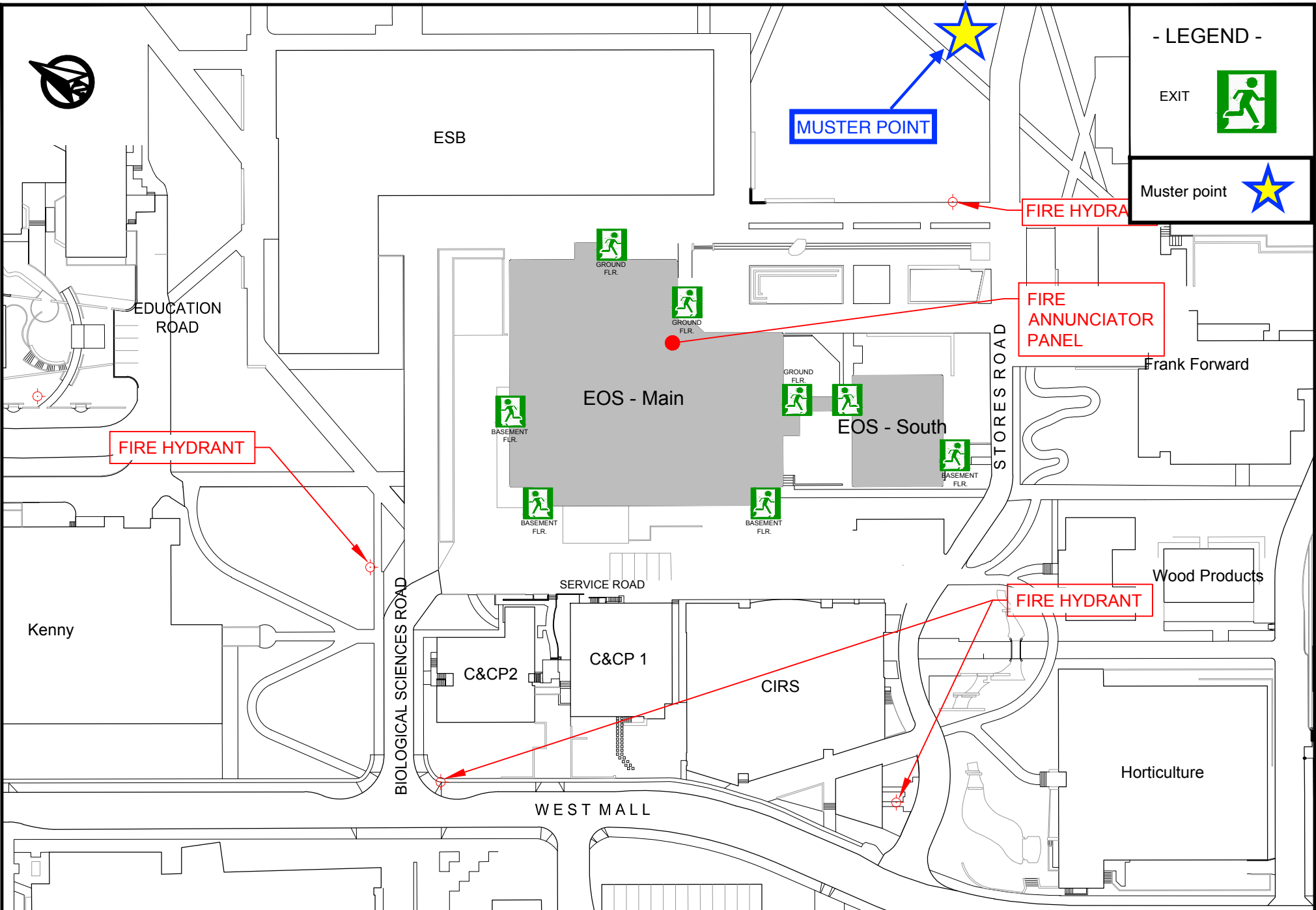

- LEGEND -

EXIT



Muster point



**FOR EMERGENCIES CALL 911**

**Earth Ocean Sciences - Main & South Building**

6339 STORES ROAD, VANCOUVER, B.C.

SITE MAP - POINT GREY CAMPUS



LAYOUT: 402-SITE 18-Dec-14